

## Filterelemente

für die Baureihen

**Pi 200, 210, 340, 360, 370, 420 und 450**

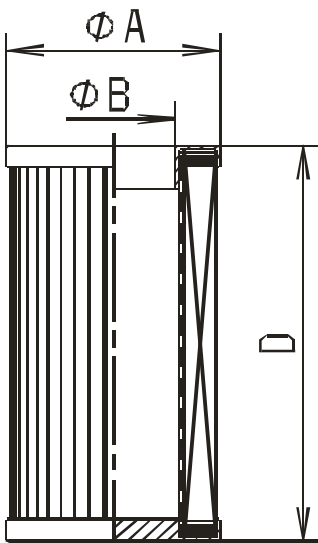

<b>Smx / Smx vst:</b>	Einweg-Filterelemente aus anorganischem Filtermaterial Feinheiten 3, 6, 10, 25 µm ( $\beta_x \geq 75$ )
<b>Drg / Drg vst :</b>	Reinigbare Filterelemente aus Edelstahl-Drahtgewebe ( bei Feinheiten < 40 µm Reinigung vorzugsweise im Ultraschallbad ) Feinheiten 10, 25, 40, 60, 100 µm
<b>Mic :</b>	Einweg-Filterelemente aus organischem Filtermaterial Feinheiten 10, 25 µm
<b>Endscheiben :</b>	Stahl verzinkt und gelb chromatiert
<b>Innenrohr :</b>	Stahl verzinkt und gelb chromatiert

[ ] Typenbezeichnung		Bestell - Nr.							( ) Filterfläche		
Nenn- größe	Smx 3	Smx 6	Smx 10	Smx 25	Smx vst 3	Smx vst 6	Smx vst 10	Smx vst 25	Maße in mm		
	Δp 20 bar	Δp 20 bar	Δp 20 bar	Δp 20 bar	Δp 210 bar	Δp 210 bar	Δp 210 bar	Δp 210 bar	A	B	D
50	[Pi 2105] 768.013.5 (590 cm <sup>2</sup> )	[Pi 5105] 794.350.9 (590 cm <sup>2</sup> )	[Pi 3105] 768.032.5 (590 cm <sup>2</sup> )	[Pi 4105] 768.044.0 (590 cm <sup>2</sup> )	[Pi 2205] 768.019.2 (470 cm <sup>2</sup> )	[Pi 5205] 794.353.3 (470 cm <sup>2</sup> )	[Pi 3205] 768.038.2 (470 cm <sup>2</sup> )	[Pi 4205] 768.050.7 (470 cm <sup>2</sup> )	47	25,5	95 <sub>.3</sub>
80	[Pi 2108] 768.014.3 (1150 cm <sup>2</sup> )	[Pi 5108] 794.351.7 (1150 cm <sup>2</sup> )	[Pi 3108] 768.034.1 (1150 cm <sup>2</sup> )	[Pi 4108] 768.045.7 (1150 cm <sup>2</sup> )	[Pi 2208] 768.020.0 (900 cm <sup>2</sup> )	[Pi 5208] 794.354.1 (900 cm <sup>2</sup> )	[Pi 3208] 768.019.0 (900 cm <sup>2</sup> )	[Pi 4208] 768.051.5 (900 cm <sup>2</sup> )	47	25,5	173 <sub>.3</sub>
110	[Pi 2111] 768.015.0 (1700 cm <sup>2</sup> )	[Pi 5111] 794.352.5 (1700 cm <sup>2</sup> )	[Pi 3111] 768.033.3 (1700 cm <sup>2</sup> )	[Pi 4111] 768.046.5 (1700 cm <sup>2</sup> )	[Pi 2211] 768.021.8 (1315 cm <sup>2</sup> )	[Pi 5211] 794.355.8 (1315 cm <sup>2</sup> )	[Pi 3211] 768.039.0 (1315 cm <sup>2</sup> )	[Pi 4211] 768.052.3 (1315 cm <sup>2</sup> )	47	25,5	249 <sub>.3</sub>
150	[Pi 2115] 768.016.8 (2425 cm <sup>2</sup> )	[Pi 5115] 795.509.9 (2425 cm <sup>2</sup> )	[Pi 3115] 768.035.8 (2425 cm <sup>2</sup> )	[Pi 4115] 768.047.3 (2425 cm <sup>2</sup> )	[Pi 2215] 768.022.6 (2010 cm <sup>2</sup> )	[Pi 5215] 795.512.3 (2010 cm <sup>2</sup> )	[Pi 3215] 768.040.8 (2010 cm <sup>2</sup> )	[Pi 4215] 768.053.1 (2010 cm <sup>2</sup> )	83	47,5	145 <sub>.3</sub>
300	[Pi 2130] 768.017.6 (4620 cm <sup>2</sup> )	[Pi 5130] 795.510.7 (4620 cm <sup>2</sup> )	[Pi 3130] 768.036.6 (4620 cm <sup>2</sup> )	[Pi 4130] 768.048.1 (4620 cm <sup>2</sup> )	[Pi 2230] 768.023.4 (3800 cm <sup>2</sup> )	[Pi 5230] 795.513.1 (3800 cm <sup>2</sup> )	[Pi 3230] 768.041.6 (3800 cm <sup>2</sup> )	[Pi 4230] 768.054.9 (3800 cm <sup>2</sup> )	83	47,5	258,5 <sub>.3</sub>
450	[Pi 2145] 768.018.4 (6865 cm <sup>2</sup> )	[Pi 5145] 795.511.5 (6865 cm <sup>2</sup> )	[Pi 3145] 768.037.4 (6865 cm <sup>2</sup> )	[Pi 4145] 768.049.9 (6865 cm <sup>2</sup> )	[Pi 2245] 768.024.2 (5600 cm <sup>2</sup> )	[Pi 5245] 795.514.9 (5600 cm <sup>2</sup> )	[Pi 3245] 768.042.4 (5600 cm <sup>2</sup> )	[Pi 4245] 768.055.6 (5600 cm <sup>2</sup> )	83	47,5	375 <sub>.3</sub>

[ ] Typenbezeichnung			Bestell - Nr.			( ) Filterfläche			Maße in mm		
Nenn- größe	Drg 10	Drg 25	Drg 40	Drg 60	Drg 100		Mic 10	Mic 25	Maße in mm		
	$\Delta p$ 20 bar	$\Delta p$ 20 bar	$\Delta p$ 20 bar	$\Delta p$ 20 bar	$\Delta p$ 20 bar		$\Delta p$ 20 bar	$\Delta p$ 20 bar	A	B	D
50	[Pi 8105] 768.089.5 (590 cm <sup>2</sup> )	[Pi 8205] 768.091.1 (590 cm <sup>2</sup> )	[Pi 8305] 768.096.0 (590 cm <sup>2</sup> )	[Pi 8405] 757.664.8 (590 cm <sup>2</sup> )	[Pi 8505] 768.106.7 (590 cm <sup>2</sup> )		[Pi 1105] 757.663.0 (640 cm <sup>2</sup> )	[Pi 1005] 771.862.0 (640 cm <sup>2</sup> )	47	25,5	95,3
80	[Pi 8108] 771.873.7 (1150 cm <sup>2</sup> )	[Pi 8208] 768.092.9 (1150 cm <sup>2</sup> )	[Pi 8308] 768.097.8 (1150 cm <sup>2</sup> )	[Pi 8408] 768.101.8 (1150 cm <sup>2</sup> )	[Pi 8508] 768.107.5 (1150 cm <sup>2</sup> )		[Pi 1108] 768.008.5 (1250 cm <sup>2</sup> )	[Pi 1008] 765.717.4 (1250 cm <sup>2</sup> )	47	25,5	173,3
110	[Pi 8111] 768.090.3 (1700 cm <sup>2</sup> )	[Pi 8211] 768.093.7 (1700 cm <sup>2</sup> )	[Pi 8311] 768.098.6 (1700 cm <sup>2</sup> )	[Pi 8411] 768.102.6 (1700 cm <sup>2</sup> )	[Pi 8511] 771.877.8 (1700 cm <sup>2</sup> )		[Pi 1111] 768.009.3 (1840 cm <sup>2</sup> )	[Pi 1011] 765.718.2 (1840 cm <sup>2</sup> )	47	25,5	249,3
150	[Pi 8115] 771.112.0 (2250 cm <sup>2</sup> )	[Pi 8215] 768.094.5 (2250 cm <sup>2</sup> )	[Pi 8315] 768.099.4 (2250 cm <sup>2</sup> )	[Pi 8415] 768.103.4 (2250 cm <sup>2</sup> )	[Pi 8515] 768.108.3 (2250 cm <sup>2</sup> )		[Pi 1115] 768.010.1 (2565 cm <sup>2</sup> )	[Pi 1015] 765.719.0 (2565 cm <sup>2</sup> )	83	47,5	145,3
300	[Pi 8130] 771.881.0 (4280 cm <sup>2</sup> )	[Pi 8230] 768.095.2 (4280 cm <sup>2</sup> )	[Pi 8330] 771.880.2 (4280 cm <sup>2</sup> )	[Pi 8430] 768.104.2 (4280 cm <sup>2</sup> )	[Pi 8530] 768.907.8 (4280 cm <sup>2</sup> )		[Pi 1130] 768.011.9 (4885 cm <sup>2</sup> )	[Pi 1030] 765.720.8 (4885 cm <sup>2</sup> )	83	47,5	258,5,3
450	[Pi 8145] 771.117.9 (6370 cm <sup>2</sup> )	[Pi 8245] 771.118.7 (6370 cm <sup>2</sup> )	[Pi 8345] 768.100.0 (6370 cm <sup>2</sup> )	[Pi 8445] 768.105.9 (6370 cm <sup>2</sup> )	[Pi 8545] 768.909.4 (6370 cm <sup>2</sup> )		[Pi 1145] 768.012.7 (7265 cm <sup>2</sup> )	[Pi 1045] 771.116.1 (7265 cm <sup>2</sup> )	83	47,5	375,3

[ ] Typenbezeichnung			Bestell - Nr.			( ) Filterfläche			Maße in mm		
Nenn- größe	Drg vst 10	Drg vst 25	Drg vst 40	Drg vst 60	Drg vst 100				Maße in mm		
	$\Delta p$ 210 bar	$\Delta p$ 210 bar	$\Delta p$ 210 bar	$\Delta p$ 210 bar	$\Delta p$ 210 bar				A	B	D
50	[Pi 9105] 768.910.2 (480 cm <sup>2</sup> )	[Pi 9205] 768.912.8 (480 cm <sup>2</sup> )	[Pi 9305] 768.916.9 (480 cm <sup>2</sup> )	[Pi 9405] 768.921.9 (480 cm <sup>2</sup> )	[Pi 9505] 768.927.6 (480 cm <sup>2</sup> )				47	25,5	95,3
80	[Pi 9108] 768.911.0 (910 cm <sup>2</sup> )	[Pi 9208] 774.095.4 (910 cm <sup>2</sup> )	[Pi 9308] 774.097.0 (910 cm <sup>2</sup> )	[Pi 9408] 768.922.7 (910 cm <sup>2</sup> )	[Pi 9508] 774.096.2 (910 cm <sup>2</sup> )				47	25,5	173,3
110	[Pi 9111] 774.101.0 (1350 cm <sup>2</sup> )	[Pi 9211] 768.913.6 (1350 cm <sup>2</sup> )	[Pi 9311] 768.917.7 (1350 cm <sup>2</sup> )	[Pi 9411] 768.923.5 (1350 cm <sup>2</sup> )	[Pi 9511] 768.928.4 (1350 cm <sup>2</sup> )				47	25,5	249,3
150	[Pi 9115] 774.103.6 (1800 cm <sup>2</sup> )	[Pi 9215] 768.914.4 (1800 cm <sup>2</sup> )	[Pi 9315] 768.918.5 (1800 cm <sup>2</sup> )	[Pi 9415] 768.924.3 (1800 cm <sup>2</sup> )	[Pi 9515] 768.929.2 (1800 cm <sup>2</sup> )				83	47,5	145,3
300	[Pi 9130] 774.107.7 (3400 cm <sup>2</sup> )	[Pi 9230] 768.915.1 (3400 cm <sup>2</sup> )	[Pi 9330] 768.919.3 (3400 cm <sup>2</sup> )	[Pi 9430] 768.925.0 (3400 cm <sup>2</sup> )	[Pi 9530] 768.930.0 (3400 cm <sup>2</sup> )				83	47,5	258,5,3
450	[Pi 9145] 774.111.9 (5020 cm <sup>2</sup> )	[Pi 9245] 774.112.7 (5020 cm <sup>2</sup> )	[Pi 9345] 768.920.1 (5020 cm <sup>2</sup> )	[Pi 9445] 768.926.8 (5020 cm <sup>2</sup> )	[Pi 9545] 768.931.8 (5020 cm <sup>2</sup> )				83	47,5	375,3

3IVF 03/2000  
3IVM 07/2007  
Änderungen vorbehalten