

Filterelemente

for filter series

Pi 200, 210, 340, 360, 370, 420 und 450

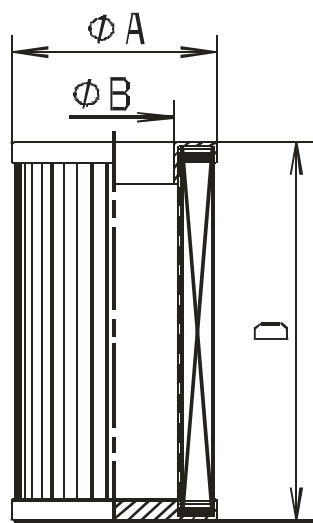

- Smx / Smx vst:** Single-use filter elements made of anorganic filter material
Retention rates 3, 6, 10, 25 μm ($\beta_x \geq 75$)
- Drg / Drg vst :** Cleanable filter elements made of stainless steel wire mesh (for retention rates $< 40 \mu\text{m}$ preferably in an ultrasonic bath)
Mesh sizes 10, 25, 40, 60, 100 μm
- Mic :** Single-use filter elements made of organic filter material
Retention rates 10, 25 μm
- End caps :** Steel, galvanized and yellow chromated
- Inner tube :** Steel, galvanized and yellow chromated

Nominal-size	[] Type designation								Order - no.			() Filter surface		
	Smx 3 Δp 20 bar	Smx 6 Δp 20 bar	Smx 10 Δp 20 bar	Smx 25 Δp 20 bar	Smx vst 3 Δp 210 bar	Smx vst 6 Δp 210 bar	Smx vst 10 Δp 210 bar	Smx vst 25 Δp 210 bar	Measures in mm					
	A	B	D											
50	[Pi 2105] 768.013.5 (590 cm ²)	[Pi 5105] 794.350.9 (590 cm ²)	[Pi 3105] 768.032.5 (590 cm ²)	[Pi 4105] 768.044.0 (590 cm ²)	[Pi 2205] 768.019.2 (470 cm ²)	[Pi 5205] 794.353.3 (470 cm ²)	[Pi 3205] 768.038.2 (470 cm ²)	[Pi 4205] 768.050.7 (470 cm ²)	47	25,5	95 _{.3}			
80	[Pi 2108] 768.014.3 (1150 cm ²)	[Pi 5108] 794.351.7 (1150 cm ²)	[Pi 3108] 768.034.1 (1150 cm ²)	[Pi 4108] 768.045.7 (1150 cm ²)	[Pi 2208] 768.020.0 (900 cm ²)	[Pi 5208] 794.354.1 (900 cm ²)	[Pi 3208] 768.019.0 (900 cm ²)	[Pi 4208] 768.051.5 (900 cm ²)	47	25,5	173 _{.3}			
110	[Pi 2111] 768.015.0 (1700 cm ²)	[Pi 5111] 794.352.5 (1700 cm ²)	[Pi 3111] 768.033.3 (1700 cm ²)	[Pi 4111] 768.046.5 (1700 cm ²)	[Pi 2211] 768.021.8 (1315 cm ²)	[Pi 5211] 794.355.8 (1315 cm ²)	[Pi 3211] 768.039.0 (1315 cm ²)	[Pi 4211] 768.052.3 (1315 cm ²)	47	25,5	249 _{.3}			
150	[Pi 2115] 768.016.8 (2425 cm ²)	[Pi 5115] 795.509.9 (2425 cm ²)	[Pi 3115] 768.035.8 (2425 cm ²)	[Pi 4115] 768.047.3 (2425 cm ²)	[Pi 2215] 768.022.6 (2010 cm ²)	[Pi 5215] 795.512.3 (2010 cm ²)	[Pi 3215] 768.040.8 (2010 cm ²)	[Pi 4215] 768.053.1 (2010 cm ²)	83	47,5	145 _{.3}			
300	[Pi 2130] 768.017.6 (4620 cm ²)	[Pi 5130] 795.510.7 (4620 cm ²)	[Pi 3130] 768.036.6 (4620 cm ²)	[Pi 4130] 768.048.1 (4620 cm ²)	[Pi 2230] 768.023.4 (3800 cm ²)	[Pi 5230] 795.513.1 (3800 cm ²)	[Pi 3230] 768.041.6 (3800 cm ²)	[Pi 4230] 768.054.9 (3800 cm ²)	83	47,5	258 _{.5.3}			
450	[Pi 2145] 768.018.4 (6865 cm ²)	[Pi 5145] 795.511.5 (6865 cm ²)	[Pi 3145] 768.037.4 (6865 cm ²)	[Pi 4145] 768.049.9 (6865 cm ²)	[Pi 2245] 768.024.2 (5600 cm ²)	[Pi 5245] 795.514.9 (5600 cm ²)	[Pi 3245] 768.042.4 (5600 cm ²)	[Pi 4245] 768.055.6 (5600 cm ²)	83	47,5	375 _{.3}			

[] Type designation			Order - no.			() Filter surface			Measures in mm		
Nominal-size	Drg 10	Drg 25	Drg 40	Drg 60	Drg 100		Mic 10	Mic 25	Measures in mm		
	Δp 20 bar	Δp 20 bar	Δp 20 bar	Δp 20 bar	Δp 20 bar		Δp 20 bar	Δp 20 bar	A	B	D
50	[Pi 8105] 768.089.5 (590 cm ²)	[Pi 8205] 768.091.1 (590 cm ²)	[Pi 8305] 768.096.0 (590 cm ²)	[Pi 8405] 757.664.8 (590 cm ²)	[Pi 8505] 768.106.7 (590 cm ²)		[Pi 1105] 757.663.0 (640 cm ²)	[Pi 1005] 771.862.0 (640 cm ²)	47	25,5	95 _{.3}
80	[Pi 8108] 771.873.7 (1150 cm ²)	[Pi 8208] 768.092.9 (1150 cm ²)	[Pi 8308] 768.097.8 (1150 cm ²)	[Pi 8408] 768.101.8 (1150 cm ²)	[Pi 8508] 768.107.5 (1150 cm ²)		[Pi 1108] 768.008.5 (1250 cm ²)	[Pi 1008] 765.717.4 (1250 cm ²)	47	25,5	173 _{.3}
110	[Pi 8111] 768.090.3 (1700 cm ²)	[Pi 8211] 768.093.7 (1700 cm ²)	[Pi 8311] 768.098.6 (1700 cm ²)	[Pi 8411] 768.102.6 (1700 cm ²)	[Pi 8511] 771.877.8 (1700 cm ²)		[Pi 1111] 768.009.3 (1840 cm ²)	[Pi 1011] 765.718.2 (1840 cm ²)	47	25,5	249 _{.3}
150	[Pi 8115] 771.112.0 (2250 cm ²)	[Pi 8215] 768.094.5 (2250 cm ²)	[Pi 8315] 768.099.4 (2250 cm ²)	[Pi 8415] 768.103.4 (2250 cm ²)	[Pi 8515] 768.108.3 (2250 cm ²)		[Pi 1115] 768.010.1 (2565 cm ²)	[Pi 1015] 765.719.0 (2565 cm ²)	83	47,5	145 _{.3}
300	[Pi 8130] 771.881.0 (4280 cm ²)	[Pi 8230] 768.095.2 (4280 cm ²)	[Pi 8330] 771.880.2 (4280 cm ²)	[Pi 8430] 768.104.2 (4280 cm ²)	[Pi 8530] 768.907.8 (4280 cm ²)		[Pi 1130] 768.011.9 (4885 cm ²)	[Pi 1030] 765.720.8 (4885 cm ²)	83	47,5	258,5 _{.3}
450	[Pi 8145] 771.117.9 (6370 cm ²)	[Pi 8245] 771.118.7 (6370 cm ²)	[Pi 8345] 768.100.0 (6370 cm ²)	[Pi 8445] 768.105.9 (6370 cm ²)	[Pi 8545] 768.909.4 (6370 cm ²)		[Pi 1145] 768.012.7 (7265 cm ²)	[Pi 1045] 771.116.1 (7265 cm ²)	83	47,5	375 _{.3}

[] Type designation			Order - no.			() Filter surface			Measures in mm		
Nominal-size	Drg vst 10	Drg vst 25	Drg vst 40	Drg vst 60	Drg vst 100				Measures in mm		
	Δp 210 bar	Δp 210 bar	Δp 210 bar	Δp 210 bar	Δp 210 bar				A	B	D
50	[Pi 9105] 768.910.2 (480 cm ²)	[Pi 9205] 768.912.8 (480 cm ²)	[Pi 9305] 768.916.9 (480 cm ²)	[Pi 9405] 768.921.9 (480 cm ²)	[Pi 9505] 768.927.6 (480 cm ²)				47	25,5	95 _{.3}
80	[Pi 9108] 768.911.0 (910 cm ²)	[Pi 9208] 774.095.4 (910 cm ²)	[Pi 9308] 774.097.0 (910 cm ²)	[Pi 9408] 768.922.7 (910 cm ²)	[Pi 9508] 774.096.2 (910 cm ²)				47	25,5	173 _{.3}
110	[Pi 9111] 774.101.0 (1350 cm ²)	[Pi 9211] 768.913.6 (1350 cm ²)	[Pi 9311] 768.917.7 (1350 cm ²)	[Pi 9411] 768.923.5 (1350 cm ²)	[Pi 9511] 768.928.4 (1350 cm ²)				47	25,5	249 _{.3}
150	[Pi 9115] 774.103.6 (1800 cm ²)	[Pi 9215] 768.914.4 (1800 cm ²)	[Pi 9315] 768.918.5 (1800 cm ²)	[Pi 9415] 768.924.3 (1800 cm ²)	[Pi 9515] 768.929.2 (1800 cm ²)				83	47,5	145 _{.3}
300	[Pi 9130] 774.107.7 (3400 cm ²)	[Pi 9230] 768.915.1 (3400 cm ²)	[Pi 9330] 768.919.3 (3400 cm ²)	[Pi 9430] 768.925.0 (3400 cm ²)	[Pi 9430] 768.930.0 (3400 cm ²)				83	47,5	258,5 _{.3}
450	[Pi 9145] 774.111.9 (5020 cm ²)	[Pi 9245] 774.112.7 (5020 cm ²)	[Pi 9345] 768.920.1 (5020 cm ²)	[Pi 9445] 768.926.8 (5020 cm ²)	[Pi 9545] 768.931.8 (5020 cm ²)				83	47,5	375 _{.3}

31VI 03/2000

Data is subject to change without notice